

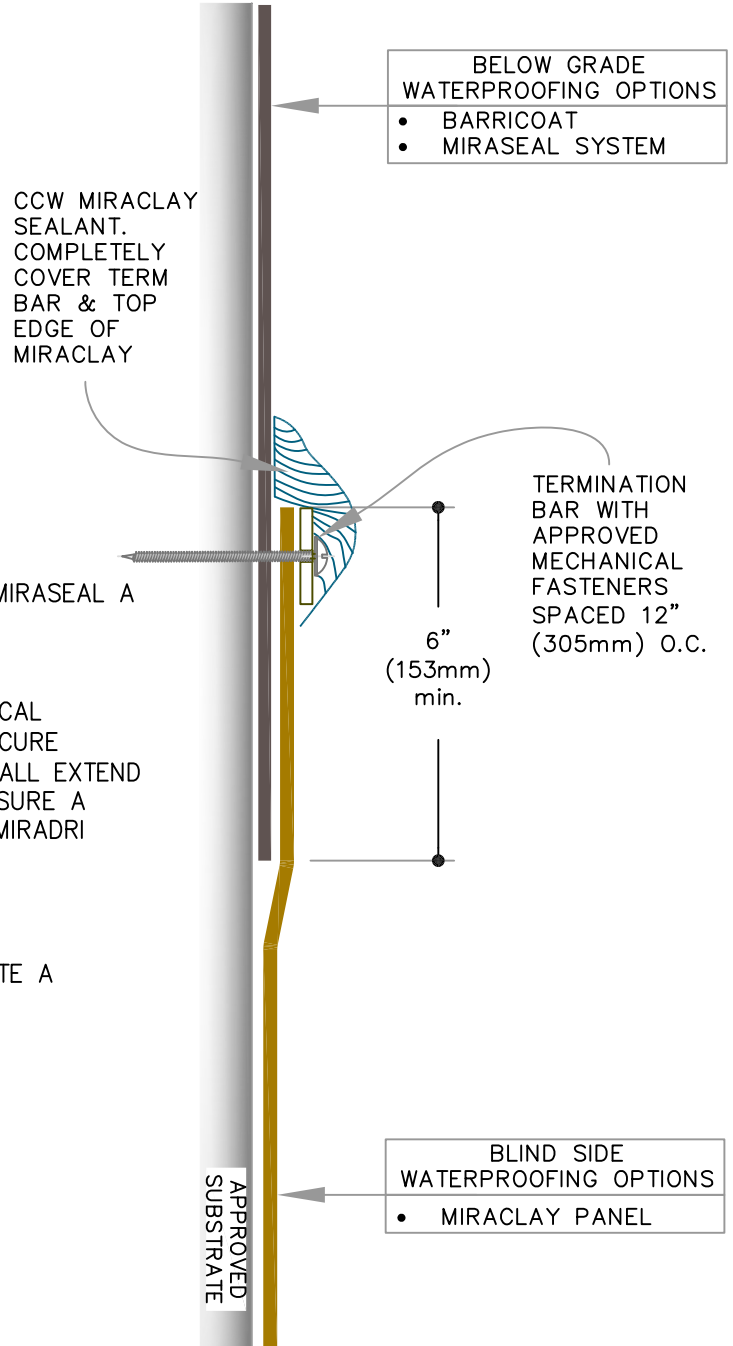

INSTALLATION STEPS:

1. LAP MIRACLAY PANEL ONTO CCW BARRICOAT OR MIRASEAL A MINIMUM OF 6" (153mm).
2. USING TERMINATION BAR AND APPROVED MECHANICAL FASTENERS SPECED 12" (305mm) ON CENTER, SECURE MIRACLAY PANEL IN PLACE. MIRACLAY PANEL SHALL EXTEND COMPLETELY BELOW THE TERMINATION BAR TO ENSURE A TOTAL COMPRESSION SEAL BETWEEN IT AND THE MIRADRI MEMBRANE.
3. APPLY MIRACLAY SEALANT TO COMPLETELY COVER TERMINATION BAR AND FASTENERS, AND TO CREATE A SMOOTH TRANSITION AT STEP-OFF.



THIS DETAIL DEPICTS PRODUCTS COMPATIBILITY ONLY. FOR COMPLETE ROOF-TO-WALL TIE-IN, PLEASE SEE [SECTION 6.](#)

	<div style="border: 1px solid red; padding: 2px; display: inline-block; text-align: center;">0</div> REFER TO NOTES	BELOW GRADE BARRIERS:	BLIND SIDE BARRIERS:	3.4
		BARRICOAT OR MIRASEAL	MIRACLAY	
REFER TO SPECS FOR ADDITIONAL INFORMATION				