

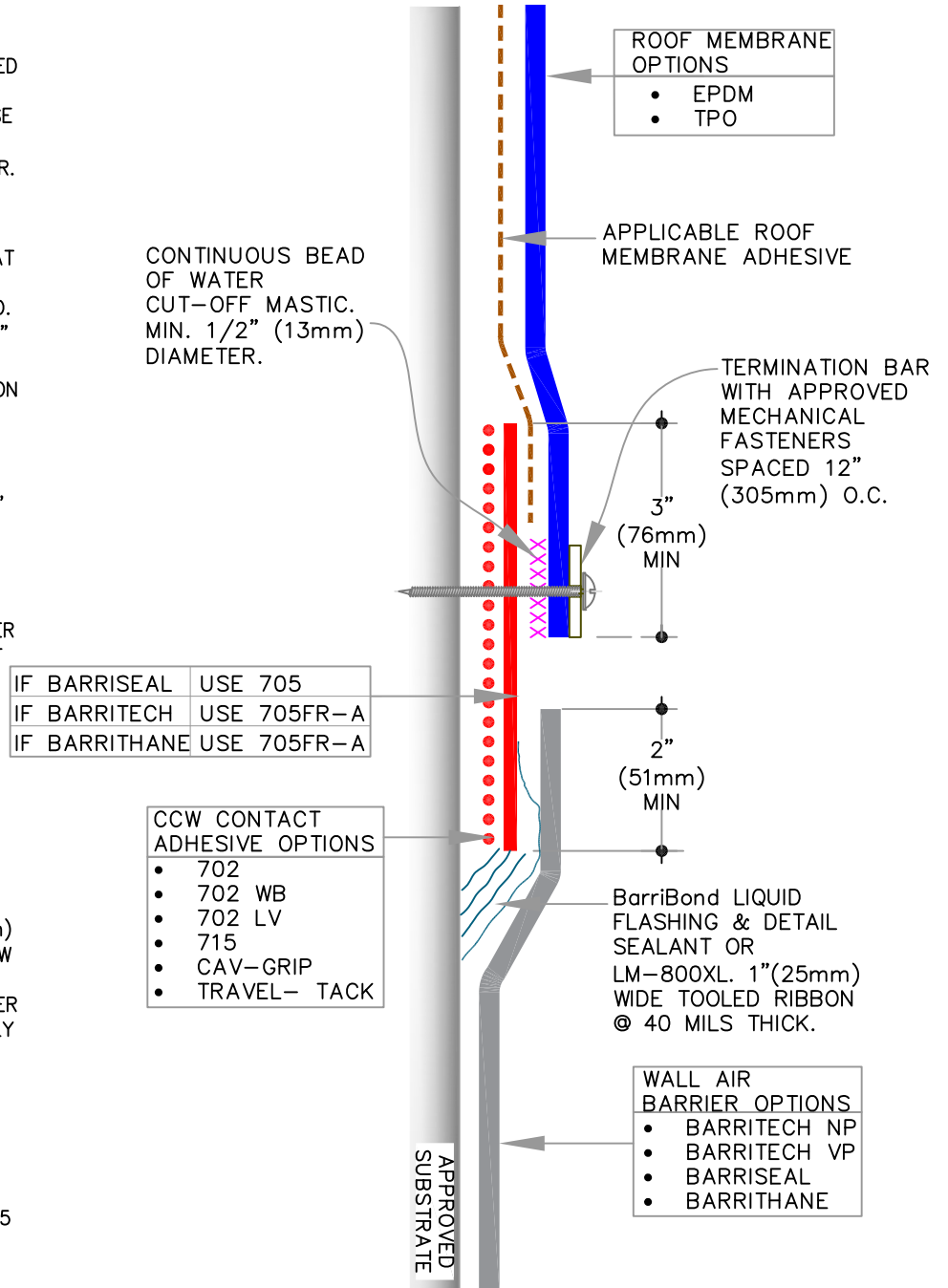

NVELOP TIE-IN DETAILS

INSTALLATION STEPS:

- 1: INSTALL A MINIMUM OF 6" (153mm) WIDE STRIP OF CCW 705 OR 705FR-A OVER PRIMED SUBSTRATE, CENTERED DIRECTLY BELOW THE PLANNED TIE-IN LOCATION. REMOVE RELEASE LINER AND PRESS INTO PLACE. ROLL TRANSITION MEMBRANE WITH 2" HAND ROLLER.
- 2: APPLY A CONTINUOUS BEAD OF CCW BARRIBOND OR LM-800XL DETAIL SEALANT AT TRANSITION MEMBRANE STEP-OFF WHERE BARRITECH OR BARRISEAL WILL BE INSTALLED. BEAD SHALL BE TOOLED TO A MINIMUM OF 1" (26mm) WIDE BY 40 MILS THICK AND ALLOWED TO DRY ACCORDING TO INSTALLATION INSTRUCTIONS.
- 3: APPLY CCW BARRITECH, BARRISEAL OR BARRITHANE ON THE WALL, CONTINUING IT 2" (51mm) ONTO TRANSITION MEMBRANE.
- 4: INSTALL EPDM/TPO ROOF MEMBRANE, EXTENDING IT A MINIMUM OF 3" (76mm) OVER CCW 705 TRANSITION MEMBRANE. CUT ROOF MEMBRANE AS STRAIGHT AS POSSIBLE TO HELP WITH ALIGNMENT OF TERMINATION BAR. ROLL OVERLAP WITH 2" HAND ROLLER TO ENSURE FULL ADHESION. ENSURE THE LAST 1" (25mm) OF THE ROOF MEMBRANE IS NOT ADHERED TO ALLOW APPLICATION OF WATER CUT-OFF MASTIC HIGHLIGHTED IN STEP 5.
- 5: APPLY A CONTINUOUS BEAD OF WATER CUT-OFF MASTIC A MINIMUM OF 1/2" (13mm) IN DIAMETER BETWEEN THE FACE OF THE CCW 705 TRANSITION MEMBRANE AND UNDERSIDE OF THE SINGLE-PLY ROOF MEMBRANE. WATER CUT-OFF MASTIC SHALL BE APPLIED DIRECTLY IN LINE WITH PLANNED TERMINATION BAR LOCATION.
- 6: WHILE MASTIC IS STILL WET, INSTALL TERMINATION BAR OVER SINGLE-PLY MEMBRANE, SANDWICHING THE MASTIC BETWEEN ROOF MEMBRANE AND THE CCW 705 TRANSITION MEMBRANE. TERMINATION BAR SHALL BE FASTENED WITH APPROVED FASTENERS AT A MINIMUM OF 12" (305mm) ON CENTER. FASTENERS SHALL PENETRATE THROUGH THE BEAD OF WATER CUT-OFF MASTIC TO ENSURE A WATER AND AIR TIGHT SEAL.



THIS DETAIL DEPICTS PRODUCTS COMPATIBILITY ONLY. FOR COMPLETE ROOF-TO-WALL TIE-IN, PLEASE SEE [SECTION 4](#).

	<div style="border: 1px solid black; padding: 2px; display: inline-block;">0</div> REFER TO NOTES	ROOF BARRIERS:	WALL BARRIERS:	1.4
		EPDM OR TPO	BARRITECH, BARRISEAL OR BARRITHANE	
REFER TO SPECS FOR ADDITIONAL INFORMATION				