

NVELOP TIE-IN DETAILS

INSTALLATION STEPS:

- 1: APPLY APPROPRIATE ROOF MEMBRANE BONDING ADHESIVE OVER SUBSTRATE AND CONTINUE IT ONTO PREVIOUSLY INSTALLED CCW 705FR-A AIR BARRIER (NOTE: STANDARD CCW-705 AND CCW-705VP ARE NOT ACCEPTABLE FOR THIS DETAIL) 2" (51mm) AND ALLOW IT TO FLASH OFF ACCORDING TO SPECIFIC ADHESIVE INSTALLATION INSTRUCTIONS.
- 2: INSTALL PVC/KEE HP ROOF MEMBRANE, EXTENDING IT A MINIMUM OF 3" (76mm) OVER THE PREVIOUSLY INSTALLED AIR BARRIER. CUT ROOF MEMBRANE AS STRAIGHT AS POSSIBLE TO HELP WITH ALIGNMENT OF TERMINATION BAR. ROLL OVERLAP WITH 2" HAND ROLLER TO ENSURE FULL ADHESION. ENSURE THE LAST 1" (26mm) OF THE ROOF MEMBRANE IS NOT ADHERED TO ALLOW APPLICATION OF UNIVERSAL SINGLE-PLY SEALANT HIGHLIGHTED IN STEP 3.
- 3: APPLY A CONTINUOUS BEAD OF UNIVERSAL SINGLE-PLY SEALANT A MINIMUM OF 1/2" (13mm) IN DIAMETER BETWEEN THE FACE OF THE 705FR-A AND UNDERSIDE OF THE SINGLE-PLY ROOF MEMBRANE. SEALANT SHALL BE APPLIED DIRECTLY IN LINE WITH PLANNED TERMINATION BAR LOCATION.
- 4: WHILE SEALANT IS STILL WET, INSTALL TERMINATION BAR OVER SINGLE-PLY MEMBRANE, SANDWICHING THE SEALANT BETWEEN THE ROOF MEMBRANE AND THE AIR BARRIER. TERMINATION BAR SHALL BE FASTENED WITH APPROVED FASTENERS SPACED A MINIMUM OF 12" (305mm) ON CENTER. FASTENERS SHALL PENETRATE THROUGH THE BEAD OF UNIVERSAL SINGLE-PLY SEALANT TO ENSURE A WATER AND AIR TIGHT SEAL.

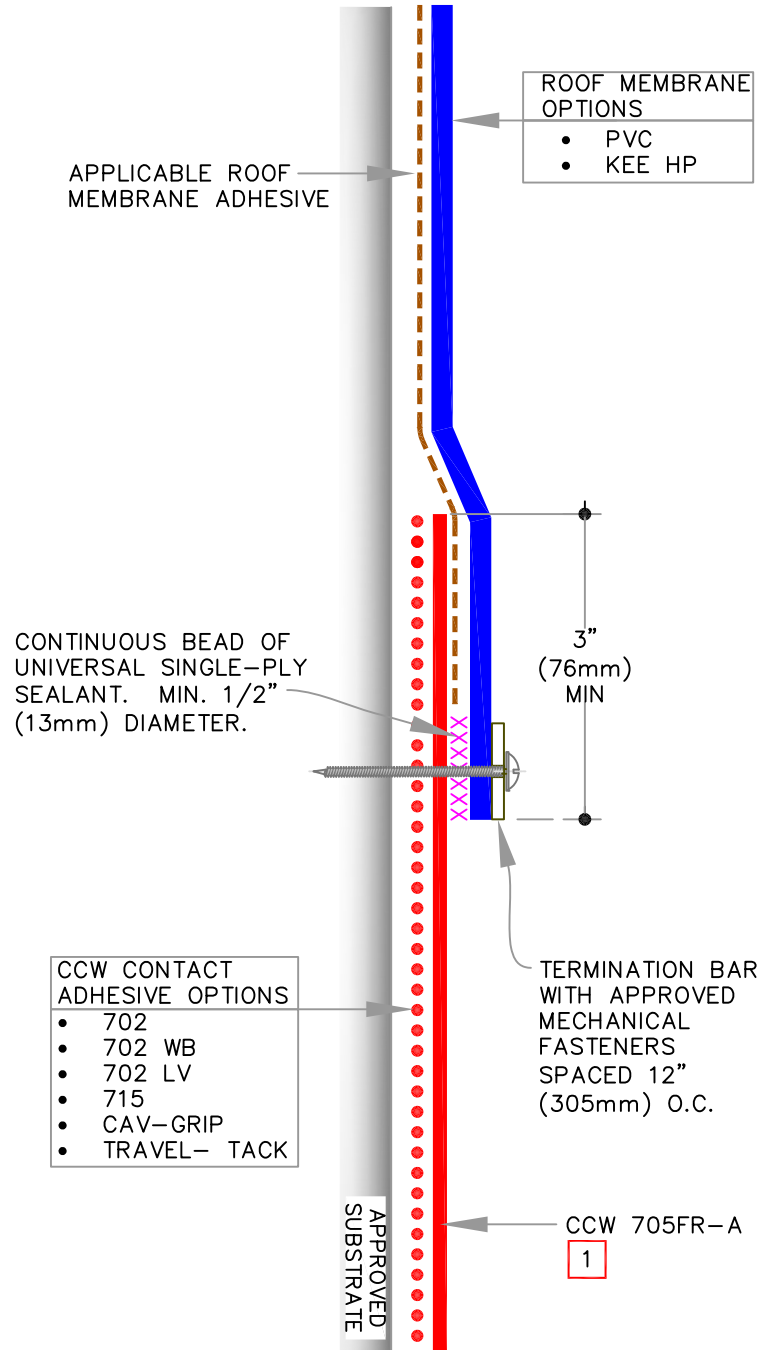

NOTES:

- 1** THIS DETAIL IS NOT APPLICABLE FOR STANDARD POLY-FACED CCW-705 OR FABRIC FACED 705VP. REFER TO NVELOP DETAIL 1.3B WHEN STANDARD CCW-705 IS USED AND DETAIL 1.3C WHEN CCW-705VP IS USED.

THIS DETAIL DEPICTS PRODUCTS COMPATIBILITY ONLY. FOR COMPLETE ROOF-TO-WALL TIE-IN, PLEASE SEE SECTION 4 .			
	0 REFER TO NOTES	ROOF BARRIERS:	WALL BARRIERS:
		PVC OR KEE HP	705FR-A
REFER TO SPECS FOR ADDITIONAL INFORMATION		1.3A	